

Photoelectric Sensors—Barrel-OM18



Description:

M18 barrel mounting mode, metal housing.
 Suitable for logistics transportation, food&beverage, printing, small equipment and others.

Features:

- Strong impact resistance
- 60m laser opposed

Technical Data:

Operating voltage	10...30VDC
Ripple voltage	≤10%
No-load current	Opposed: ≤25mA; Others: ≤15mA
Output current	≤100mA
Protective circuit	Reverse polarity protection, short circuit protection, overload protection
Sensitivity	Adjustable, with single-turn knob
Output indicator	Red LED
Steady state indicator	Green LED
Ambient temperature	-25...65°C
Storage temperature	-40...70°C
Voltage resistance	1000V/AC 50/60Hz 60s
Insulation impedance	≥50MΩ(500VDC)
Shock resistance	Complex amplitude 1.5mm 10... 50Hz (2hr X, Y ,Z respectively)
Impact resistance	500m/S ² (50G) 3 times X,Y,Z respectively
Protection class	IP67
Housing material	Brass nickel-plated

Type:

Detection mode	Type	Distance	Light source	Frequency	Output	Switching mode	Connection	Wiring
Opposed	OM18-S6(emitter)	10m	Infrared	---	---	---	2m cable	Fig.1
	OM18-EVP6 (receiver)		---	100Hz	PNP	NO+NC	2m cable	Fig.3
	OM18-EVN6 (receiver)		---	100Hz	NPN	NO+NC	2m cable	Fig.4
	OM18-S6Q (emitter)	10m	Infrared	---	---	---	M12 connector	Fig.2
	OM18-EVP6Q (receiver)		---	100Hz	PNP	NO+NC	M12 connector	Fig.5
	OM18-EVN6Q (receiver)		---	100Hz	NPN	NO+NC	M12 connector	Fig.6
	OM18-SL306	30m	laser	---	---	---	2m cable	Fig.1
	OM18-EL30VP6		laser	800Hz	PNP	NO+NC	2m cable	Fig.3
	OM18-EL30VN6		laser	800Hz	NPN	NO+NC	2m cable	Fig.4
	OM18-SL306Q	30m	laser	---	---	---	M12 connector	Fig.2
	OM18-EL30VP6Q		laser	800Hz	PNP	NO+NC	M12 connector	Fig.5
	OM18-EL30VN6Q		laser	800Hz	NPN	NO+NC	M12 connector	Fig.6
	OM18-SL606	60m	laser	---	---	---	2m cable	Fig.1
	OM18-EL60VP6		laser	800Hz	PNP	NO+NC	2m cable	Fig.3
	OM18-EL60VN6		laser	800Hz	NPN	NO+NC	2m cable	Fig.4
	OM18-SL606Q	60m	laser	---	---	---	M12 connector	Fig.2
OM18-EL60VP6Q	laser		800Hz	PNP	NO+NC	M12 connector	Fig.5	
OM18-EL60VN6Q	laser		800Hz	NPN	NO+NC	M12 connector	Fig.6	

The detection distance corresponds to the reflector RB50*50-1 (purchased separately)

Retro-reflective	OM18-RVP6	3m	Infrared	100Hz	PNP	NO+NC	2m cable	Fig.3
	OM18-RVN6	3m	Infrared	100Hz	NPN	NO+NC	2m cable	Fig.4
	OM18-RVP6Q	3m	Infrared	100Hz	PNP	NO+NC	M12 connector	Fig.5
	OM18-RVN6Q	3m	Infrared	100Hz	NPN	NO+NC	M12 connector	Fig.6
Polarized retro-reflective	OM18-RPVP6	3m	Red	800Hz	PNP	NO+NC	2m cable	Fig.3
	OM18-RPVN6	3m	Red	800Hz	NPN	NO+NC	2m cable	Fig.4
	OM18-RPVP6Q	3m	Red	800Hz	PNP	NO+NC	M12 connector	Fig.5
	OM18-RPVN6Q	3m	Red	800Hz	NPN	NO+NC	M12 connector	Fig.6

Diffused	OM18-K100VP6	100mm	Infrared	100Hz	PNP	NO+NC	2m cable	Fig.3
	OM18-K100VN6	100mm	Infrared	100Hz	NPN	NO+NC	2m cable	Fig.4
	OM18-K100VP6Q	100mm	Infrared	100Hz	PNP	NO+NC	M12 connector	Fig.5
	OM18-K100VN6Q	100mm	Infrared	100Hz	NPN	NO+NC	M12 connector	Fig.6
	OM18-K200VP6	200mm	Infrared	100Hz	PNP	NO+NC	2m cable	Fig.3
	OM18-K200VN6	200mm	Infrared	100Hz	NPN	NO+NC	2m cable	Fig.4
	OM18-K200VP6Q	200mm	Infrared	100Hz	PNP	NO+NC	M12 connector	Fig.5
	OM18-K200VN6Q	200mm	Infrared	100Hz	NPN	NO+NC	M12 connector	Fig.6
	OM18-K400VP6	400mm	Infrared	100Hz	PNP	NO+NC	2m cable	Fig.3
	OM18-K400VN6	400mm	Infrared	100Hz	NPN	NO+NC	2m cable	Fig.4
	OM18-K400VP6Q	400mm	Infrared	100Hz	PNP	NO+NC	M12 connector	Fig.5
	OM18-K400VN6Q	400mm	Infrared	100Hz	NPN	NO+NC	M12 connector	Fig.6
	OM18-K600VP6	600mm	Infrared	100Hz	PNP	NO+NC	2m cable	Fig.3
	OM18-K600VN6	600mm	Infrared	100Hz	NPN	NO+NC	2m cable	Fig.4
	OM18-K600VP6Q	600mm	Infrared	100Hz	PNP	NO+NC	M12 connector	Fig.5
	OM18-K600VN6Q	600mm	Infrared	100Hz	NPN	NO+NC	M12 connector	Fig.6

Photoelectric Sensors—Barrel-OM18

Wiring:

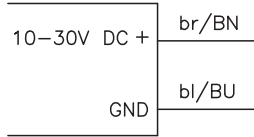

Fig.1

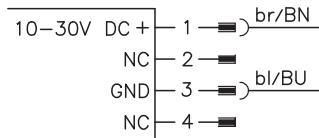

Fig.2

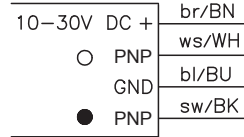

Fig.3

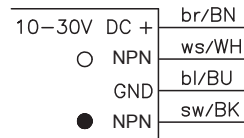

Fig.4

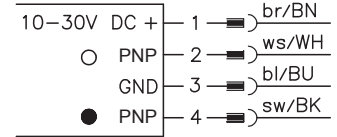

Fig.5

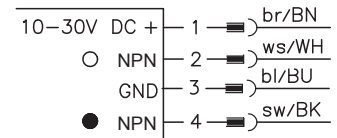
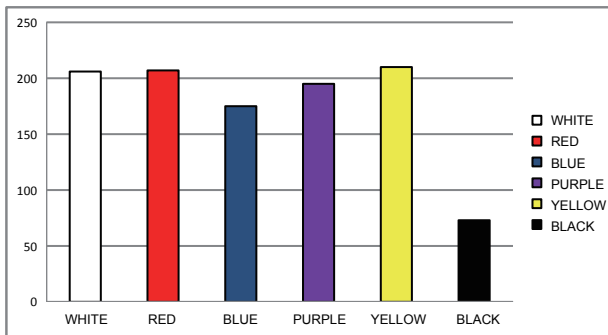

Fig.6

Attenuation figure:

OM18-K100VP6



OM18-K200VP6

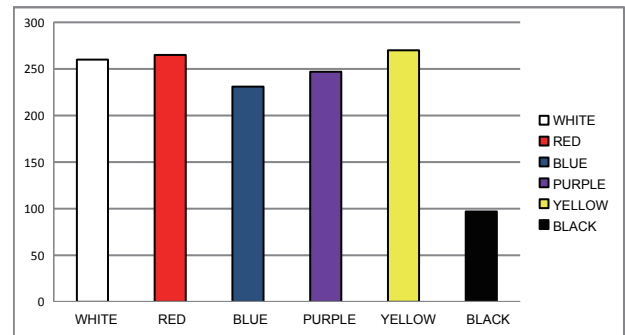

OM18-K400VP6

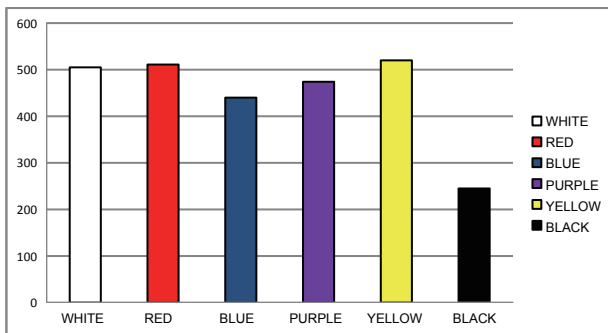

OM18-K600VP6

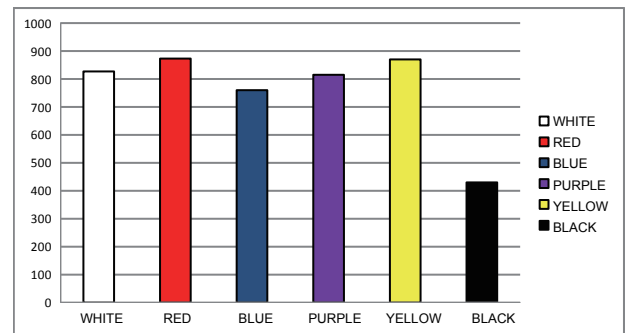

Translation characteristic curve:

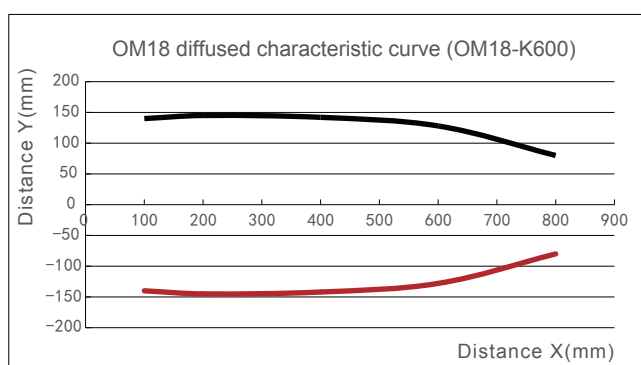
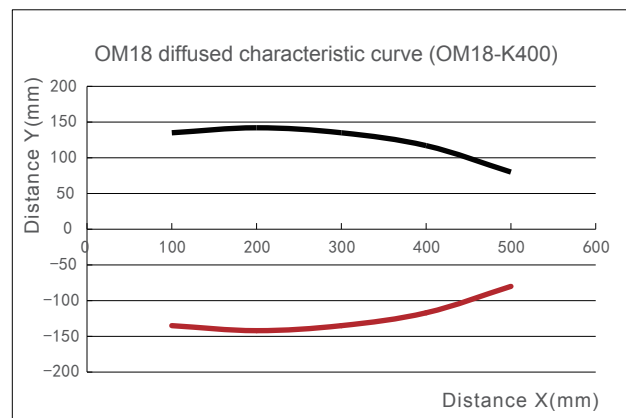
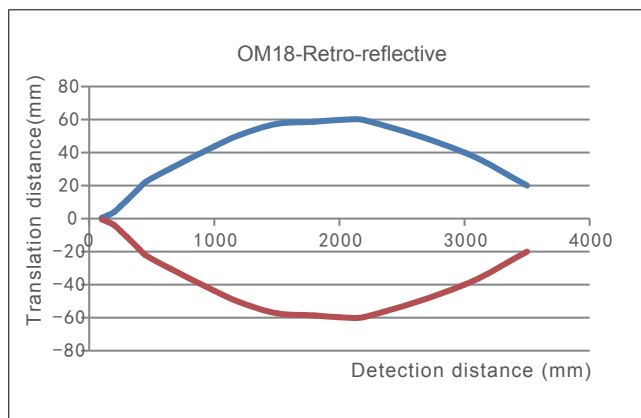
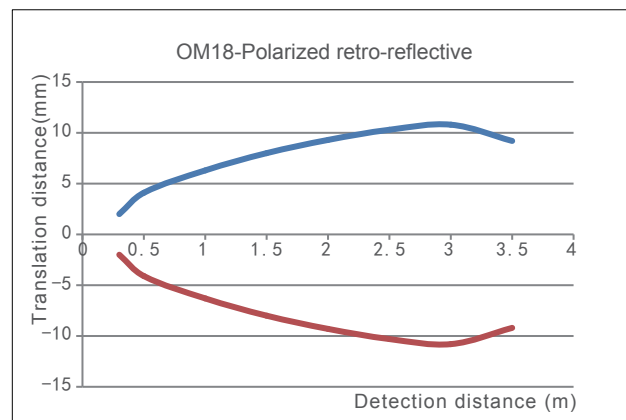
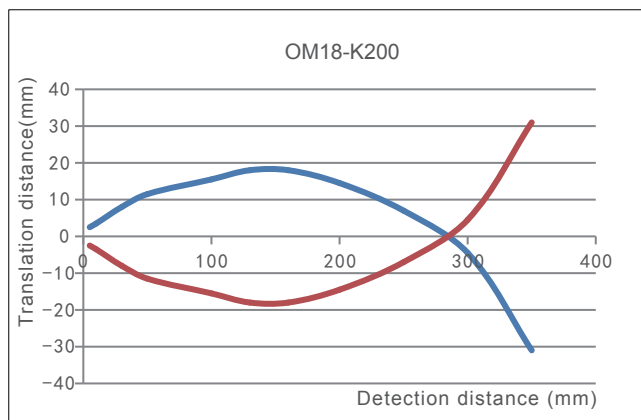
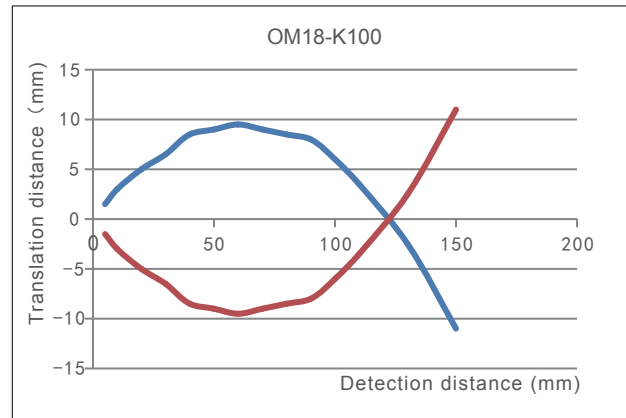
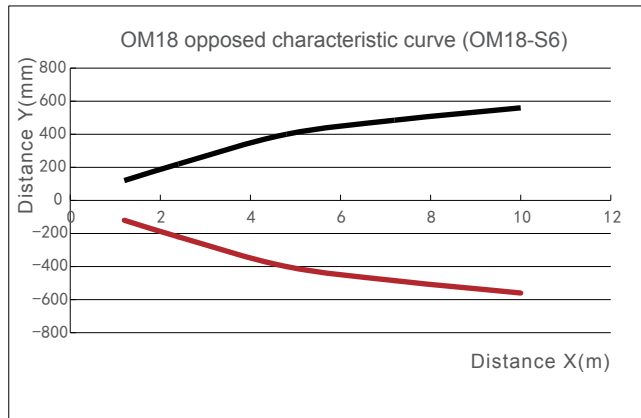

Photoelectric Sensors—Barrel-OM18

Beam Pattern:

OM18-S6 (mm)

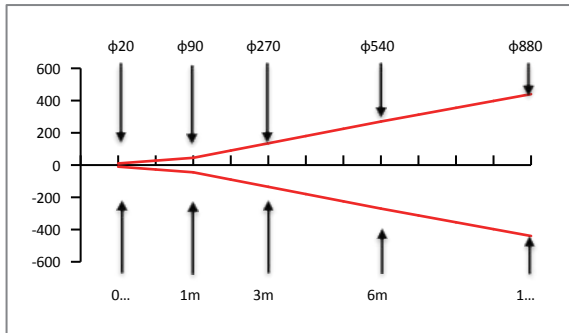

OM18-SL (mm)

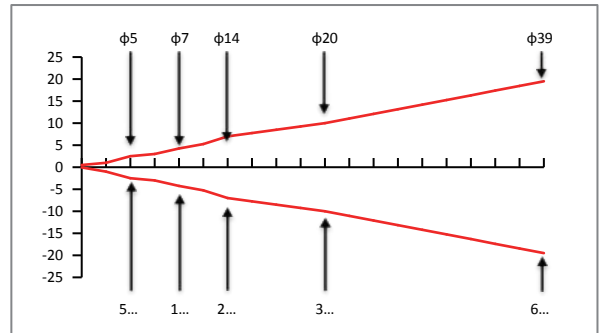

OM18-R (mm)

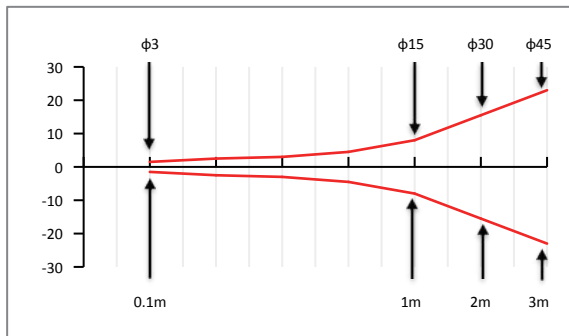

OM18-RP (mm)

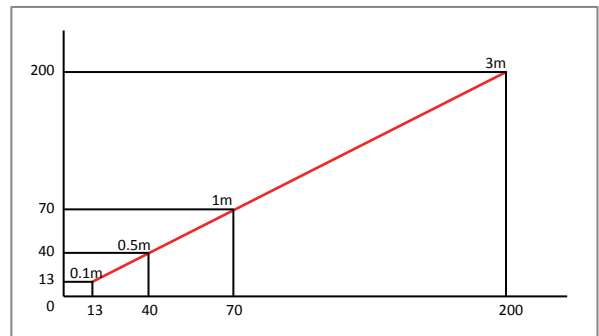

OM18-K100/200 (mm)

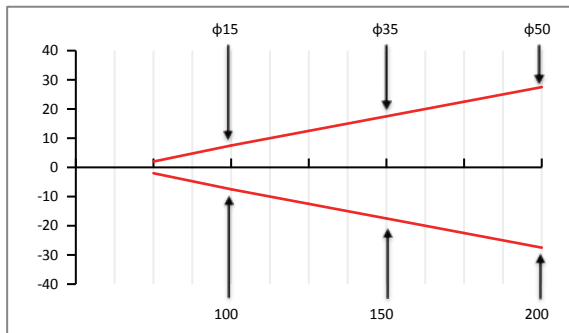

OM18-K400/600 (mm)

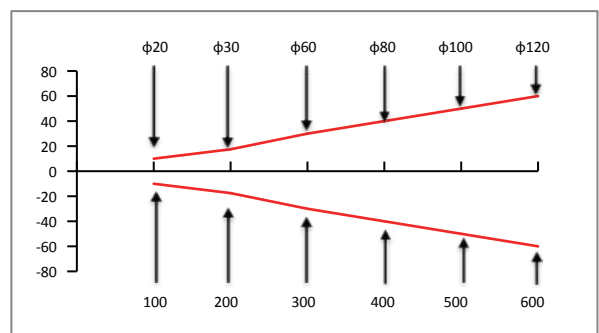

Dimensions:

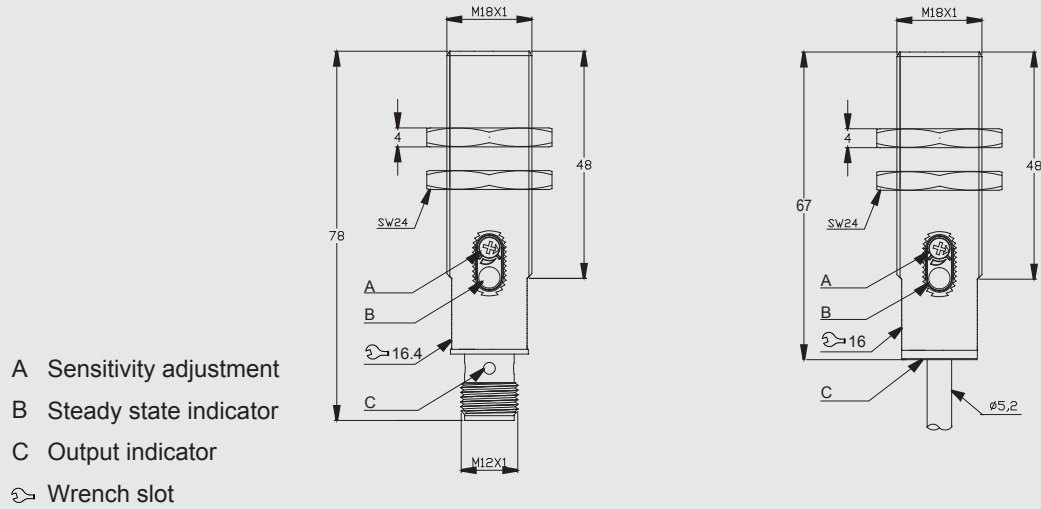

Mounting bracket (optional):

EO18DF

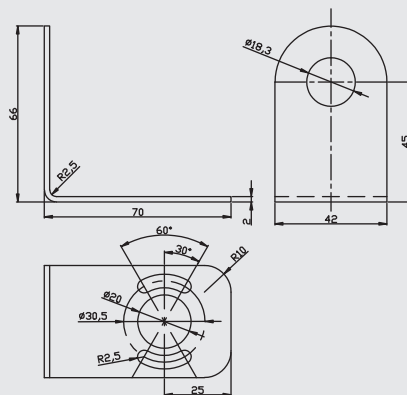

Reflector (optional):

RB50x50-1

